

SHEET INDEX	
SHT NO.	DESCRIPTION
1	COVER SHEET
2	EXISTING AND PROPOSED ROAD CROSS SECTIONS
3	DETAILS, LEGEND AND NOTES
4	NORTH SHORE DRIVE EXISTING CONDITIONS STA. 0+00 TO 20+00
5	NORTH SHORE DRIVE EXISTING CONDITIONS STA. 20+00 TO 46+00
6	NORTH SHORE DRIVE REMOVALS PLAN STA. 0+00 TO 30+00
7	REMOVAL PLANS NORTH SHORE STA 30+00 TO 46+00, DYCKMAN STA 100+00 TO 103+75, NEWCOME STA 500+00 TO 503+75
8	DYCKMAN AVE. ROAD WORK AND SANITARY SEWER PLAN AND PROFILE STA. 100+00 TO 103+75
9	ROAD WORK AND STORM SEWER PLAN AND PROFILE STA. 0+00 TO 5+00
10	WATER AND SANITARY SEWER PLAN AND PROFILE STA 0+00 TO 5+00
11	ROAD WORK AND STORM SEWER PLAN AND PROFILE STA. 5+00 TO 10+00
12	WATER AND SANITARY SEWER PLAN AND PROFILE STA. 5+00 TO 10+00
13	ROAD WORK AND STORM SEWER PLAN AND PROFILE STA. 10+00 TO 15+00
14	WATER AND SANITARY SEWER PLAN AND PROFILE STA. 10+00 TO 15+00
15	ROAD WORK AND STORM SEWER PLAN AND PROFILE STA. 15+00 TO 20+00
16	WATER AND SANITARY SEWER PLAN AND PROFILE STA. 15+00 TO 20+00
17	ROAD WORK AND STORM SEWER PLAN AND PROFILE STA. 20+00 TO 25+00
18	WATER AND SANITARY SEWER PLAN AND PROFILE STA. 20+00 TO 25+00
19	ROAD WORK AND STORM SEWER PLAN AND PROFILE STA. 25+00 TO 30+00
20	WATER AND SANITARY SEWER PLAN AND PROFILE STA. 25+00 TO 30+00
21	ROAD WORK AND STORM SEWER PLAN AND PROFILE STA. 30+00 TO 35+00
22	WATER AND SANITARY SEWER PLAN AND PROFILE STA. 30+00 TO 35+00
23	ROAD WORK AND STORM SEWER PLAN AND PROFILE STA. 35+00 TO 40+00
24	WATER AND SANITARY SEWER PLAN AND PROFILE STA. 35+00 TO 40+00
25	ROAD WORK AND STORM SEWER PLAN AND PROFILE STA. 40+00 TO 44+00
26	WATER AND SANITARY SEWER PLAN AND PROFILE STA. 40+00 TO 44+00
27	ROAD WORK AND STORM SEWER PLAN AND PROFILE STA. 44+00 TO 46+00
28	WATER AND SANITARY SEWER PLAN AND PROFILE STA. 44+00 TO 46+00
29	NEWCOME PLAN & PROFILE STA 500+00 TO 503+75
30	PACKARD PARK PLAN VIEW
31	INTERSECTION DETAILS - 1
32	INTERSECTION DETAILS - 2
33	TRAFFIC MAINTENANCE PLAN - 1
34	TRAFFIC MAINTENANCE PLAN - 2
35	TRAFFIC MAINTENANCE PLAN - 3
36	SIGNAGE PLAN AND PAVEMENT MARKING
37	SIGNAGE PLAN AND PAVEMENT MARKING
38	SOIL EROSION CONTROL AND SEDIMENTATION PLAN
39	SOIL EROSION CONTROL AND SEDIMENTATION PLAN
40	LANDSCAPE PLAN - 1 STA 0+00 TO 24+00
41	LANDSCAPE PLAN - 2 STA 24+00 TO 46+00
42	LANDSCAPE INTERSECTION DETAILS
43	LANDSCAPING DETAILS
44	STAIRS PLAN
45	STAIRS EXTERIOR ELEVATIONS - 1
46	STAIRS EXTERIOR ELEVATIONS - 2
47	STAIRS EXTERIOR ELEVATIONS - 3
48	STAIRS 3D VIEW
49	STAIRS CONSTRUCTION DETAILS
50	STAIRS FOUNDATION AND FRAMING PLAN
51	STAIRS FOUNDATION DETAILS

# CITY OF SOUTH HAVEN

## CONTRACT #1 - NORTH SHORE DRIVE RECONSTRUCTION PROJECT

### CITY OF SOUTH HAVEN OFFICIALS

MAYOR	ROBERT BURR
CITY COUNCIL MEMBER - WARD ONE	SCOTT SMITH
CITY COUNCIL MEMBER - WARD ONE	VICKY KOZLIK WALL
CITY COUNCIL MEMBER - WARD TWO	JEFF ARNOLD
CITY COUNCIL MEMBER - WARD TWO	CLARK GRUBER
CITY COUNCIL MEMBER - WARD THREE	ANDY KLAVINS
CITY COUNCIL MEMBER - WARD THREE	STEVE SCHLACK
CITY MANAGER	BRIAN DISSETTE
CITY ENGINEER	LARRY HALBERSTADT, PE

### LOCAL UTILITIES

**GAS:**  
MICHIGAN GAS UTILITIES  
SCOTT PURUCKER  
711 STARLITE DR.  
BENTON HARBOR, MI 49022  
(269) 927-5531

**SEWER & WATER:**  
CITY OF SOUTH HAVEN  
PUBLIC WORKS  
RON DOTSON  
1199 8TH AVENUE  
SOUTH HAVEN, MI 49090  
(269) 637-0719

**ELECTRIC:**  
CITY OF SOUTH HAVEN  
ELECTRIC DEPT.  
JIM PEZZUTO  
1199 8TH AVENUE  
SOUTH HAVEN, MI 49090  
(269) 637-0756

**CABLE:**  
COMCAST  
JOE SCHOPF  
11921 EAST M-89  
RICHLAND, MI 49083  
(269) 203-7199

**TELEPHONE:**  
FRONTIER COMMUNICATIONS  
MIKE KARLE  
601 N. US-131  
THREE RIVERS, MI 49093  
(269) 273-0383

**INTERNET:**  
BLOOMINGDALE COMMUNICATIONS  
P.O. BOX 187  
101 W. KALAMAZOO STREET  
BLOOMINGDALE, MI 49026  
MR. DAN KEY  
(269) 521-7300  
DKEY@BLOOMINGDALECOM.NET

MERIT NETWORK INC.  
1000 OAKBROOK DRIVE, SUITE 200  
ANN ARBOR, MI 48104-6794  
(734) 527-5700  
WWW.MERIT.EDU

### CALL MISS DIG

1-800-482-7171 OR 811

FOR PROTECTION OF THE UNDERGROUND UTILITIES, THE CONTRACTOR SHALL CALL MISS DIG A MINIMUM OF THREE FULL WORKING DAYS, EXCLUDING SATURDAYS, SUNDAYS, AND HOLIDAYS PRIOR TO BEGINNING CONSTRUCTION OPERATIONS. MEMBERS WILL THUS BE ROUTINELY NOTIFIED. THIS DOES NOT RELIEVE THE CONTRACTOR OF THE RESPONSIBILITY OF NOTIFYING UTILITY OWNERS WHO MAY NOT BE PART OF THE "MISS DIG" ALERT SYSTEM.



Know what's below.  
Call before you dig.



### MDOT STANDARD PLAN SERIES

- R-28 SIDEWALK RAMP AND DETECTABLE WARNING DETAILS
- R-29 DRIVEWAY OPENINGS & APPROACHES AND CONCRETE SIDEWALKS
- R-30 CONCRETE CURB AND CONCRETE CURB & GUTTER
- R-96 SOIL EROSION & SEDIMENTATION CONTROL MEASURES
- R-100 SEEDING AND TREE PLANTING

### TRAFFIC AND SAFETY STANDARD PLANS

- WZD-100-A GROUND DRIVEN SIGN SUPPORTS FOR TEMPORARY SIGNS \*
- WZD-125-E TEMPORARY TRAFFIC CONTROL DEVICES\*

\* DENOTES SPECIAL DETAIL

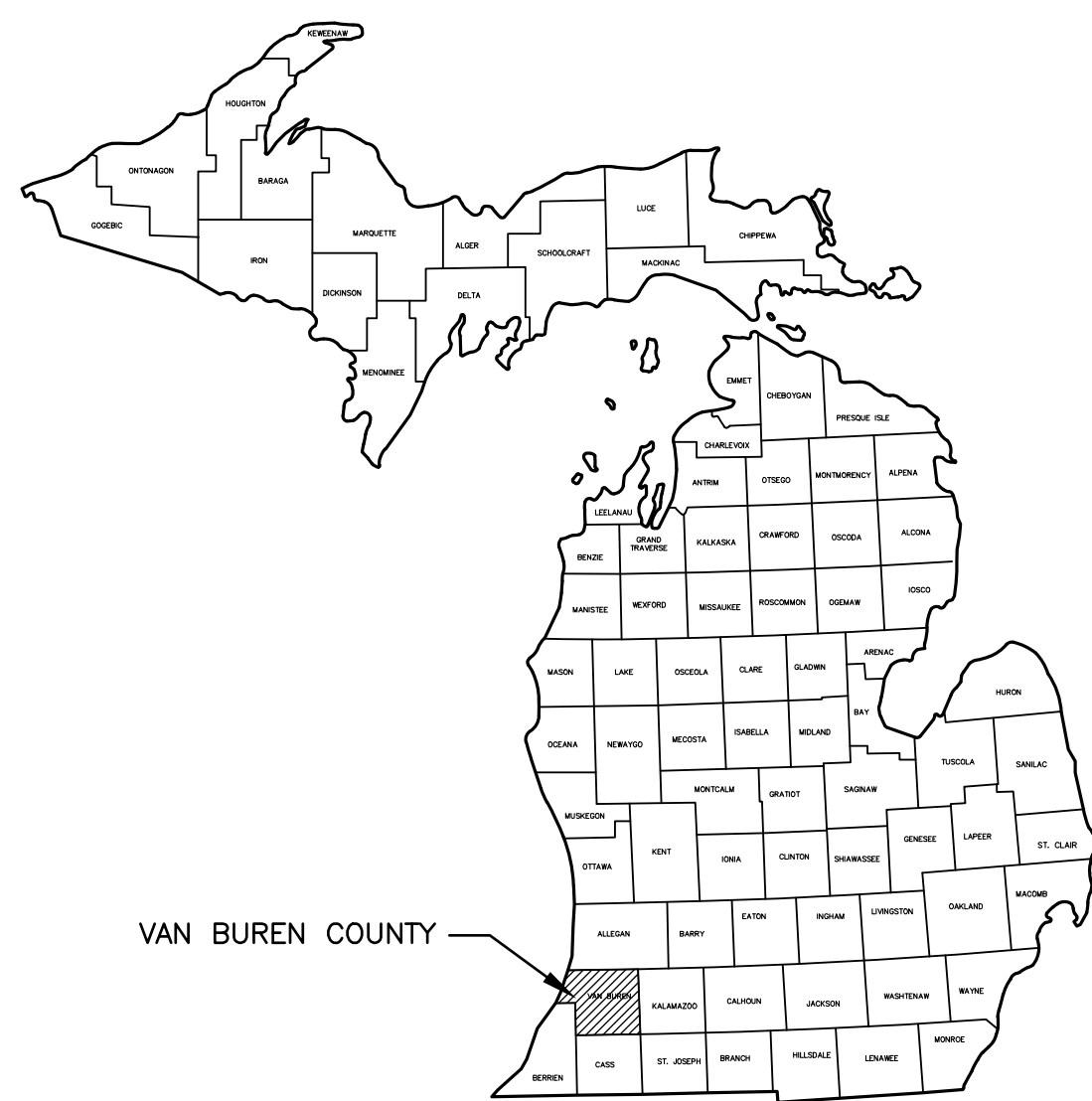

VAN BUREN COUNTY

### COUNTY KEY

### NOTES:

EXCEPT WHERE OTHERWISE INDICATED ON THESE PLANS OR IN THE PROPOSAL AND SUPPLEMENTAL SPECIFICATIONS CONTAINED THEREIN, ALL MATERIALS AND WORKMANSHIP SHALL BE IN ACCORDANCE WITH THE 2012 MICHIGAN DEPARTMENT OF TRANSPORTATION STANDARD SPECIFICATIONS FOR CONSTRUCTION.

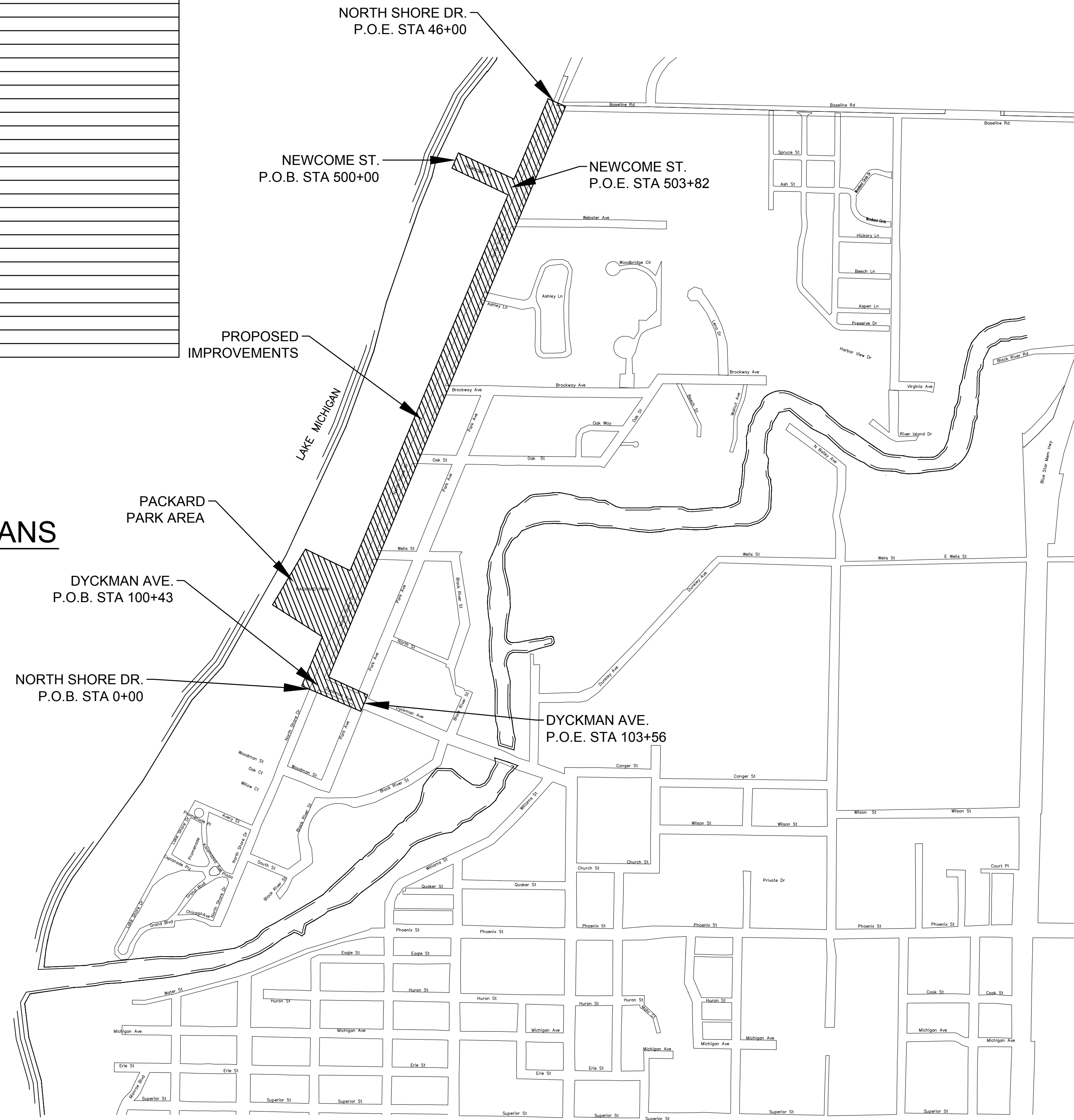

### PROJECT LOCATION MAP

NOT TO SCALE